



OUTDOOR DOWN DISCHARGE MOD PACKAGE UNIT, V-BANK, EVAPORATIVE COOLER INTAKE, SCREEN INTAKE AND OPTIONAL MIXING BOX

STV3E3C832MM-H*P0
REV#E 06/12/2015

CONDENSER INFORMATION

MODEL	WEIGHT#	#1	#2	CC	DD	EE
2 TON-G10	119 LBS	2 TON	N/A	26-5/16	56-1/16	52-3/8
3 TON-G10	134 LBS	3 TON	N/A	33-5/16	63-1/16	59-3/8
4 TON-G10	153 LBS	4 TON	N/A	39-1/4	69-1/4	65-3/8
5 TON-G10	177 LBS	5 TON	N/A	45-1/4	75-1/4	71-3/8
6 TON-G10	202 LBS	6 TON	N/A	51-1/4	81-1/4	77-3/8
7 1/2 TON-G12	197 LBS	5 TON	N/A	32-13/16	69-9/16	65-7/8
7 1/2 TON-G12	197 LBS	5 TON	N/A	32-13/16	69-9/16	65-7/8
8 TON-G12	225 LBS	5 TON	N/A	32-13/16	69-9/16	65-7/8
9 TON-G12	255 LBS	5 TON	N/A	32-13/16	69-9/16	65-7/8
10 TON-G12	294 LBS	5 TON	N/A	32-13/16	69-9/16	65-7/8
10 TON-G15	331 LBS	3 TON	N/A	32-13/16	69-9/16	65-7/8
10 TON-G15	331 LBS	3 TON	N/A	32-13/16	69-9/16	65-7/8
10 TON-G18	394 LBS	5 TON	N/A	32-13/16	69-9/16	65-7/8
10 TON-G18	394 LBS	5 TON	N/A	32-13/16	69-9/16	65-7/8
10 TON-G18	394 LBS	5 TON	N/A	32-13/16	69-9/16	65-7/8
10 TON-G20	457 LBS	5 TON	N/A	32-13/16	69-9/16	65-7/8
10 TON-G20	457 LBS	5 TON	N/A	32-13/16	69-9/16	65-7/8

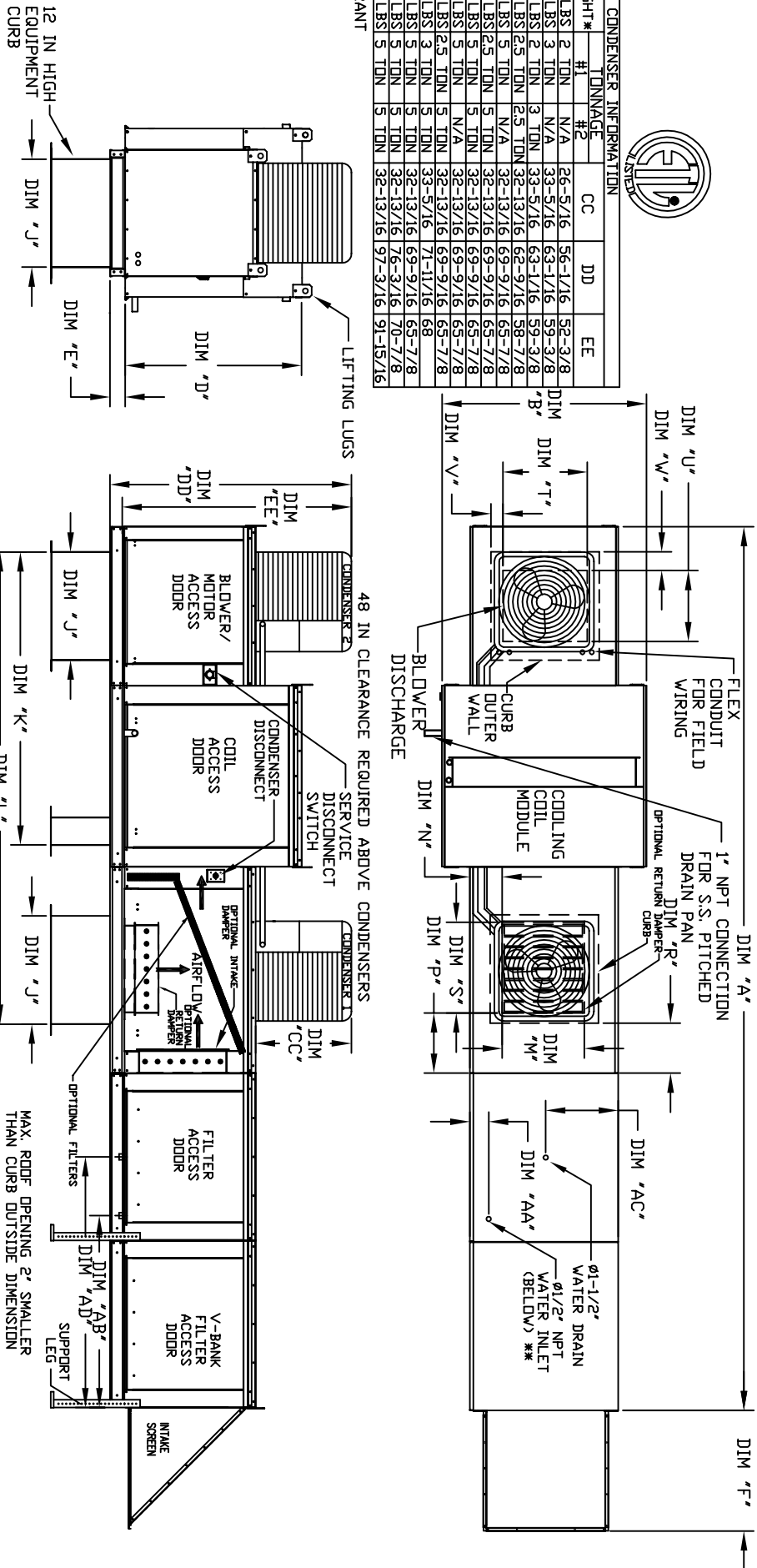

ALL DIMENSIONS ARE NOMINAL AND GIVEN IN INCHES.

MODEL	UNIT DIMENSIONS													STANDARD EVAPORATIVE COOLING UNIT					CELDEX EVAPORATIVE COOLING UNIT					OPTIONAL MIXING BOX FILTERS																																																	
	A	B	C	D	E	F	J	K	L	M	N	P	R	S	T	U	V	V	MIN	MAX	WATER INLET DRAIN OPENING	AA	AB	AC	AD																																																
G10	181-1/8	39-3/8	42-3/4	39	3-3/4	22-3/8	21	98-5/8	14	8	14	12-1/2	18	13-1/4	11-1/2	3-7/8	1-3/4	2 Ton	5 Ton	4-1/2	38-1/2	13	48-1/4	13																																																	
G12	189-1/8	49-3/8	47-3/4	44	3-3/4	30-5/16	31	112-5/8	22-3/4	8	11	7-1/2	24	15-3/4	13-9/16	7-5/8	1-5/16	5 Ton	10 Ton	4-1/2	38-1/2	18	48-1/4	18																																																	
G15	189-1/8	49-3/8	47-3/4	44	3-3/4	30-5/16	31	112-5/8	22-3/4	8	11	7-1/2	24	15-3/4	13-9/16	6-1/8	5-1/2	5 Ton	10 Ton	4-1/2	38-1/2	18	48-1/4	18																																																	
G18	206-1/8	54-3/8	56-3/8	51-1/8	5-1/4	34-3/16	35	120-1/8	28	8	7	4-1/2	30	22	19	6-1/2	5-1/2	10 Ton	10 Ton	4-1/2	44	20	57-1/4	20																																																	
920	243-9/16	60-7/16	64-3/8	59-1/8	5-1/4	47-1/4	42	104-9/32	33	10	11	8	36	24-7/8	24-7/8	8-9/16	1-1/8	10 Ton	10 Ton	4-1/2	41-1/8	23	152-7/8	23																																																	
UNIT INFORMATION																						MAX. FILTER VELOCITY													TIT. WEIGHT					OPTIONAL MIXING BOX FILTERS																																	
FILT. SIZE & QTY																						965 LBS					20"x25"x2" (3)					406 FPM		6		3 GPH		970 LBS		20"x24"x12"					10"x16"x2" (3)					20"x25"x2" (2)		16"x23"x2" (1)		20"x25"x2" (2)		16"x23"x2" (1)		15"x20"x2" (4)		15"x15"x2" (2)		18"x25"x2" (4)		16"x20"x2" (2)									
FILT. WEIGHT																						20"x25"x2" (3)					1345 LBS					16"x20"x2" (8)					358 FPM		10		5 GPH		1350 LBS		25"x22"x12"					1080 FPM					20		6.5 GPH		1080 FPM		20		6.5 GPH		15"x20"x2" (4)		15"x15"x2" (2)		18"x25"x2" (4)		16"x20"x2" (2)		
MEDIA SIZE & QTY VEL. @ MAX. CFM/NZ/ZE/SE/MS/FLW RATE																						20"x25"x2" (3)					16"x20"x2" (8)					429 FPM		10		5 GPH		1665 LBS		30"x36"x12"					1067 FPM					28		8.4 GPH		1665 LBS		38"x43"x12"					1322 FPM					35		1015 GPH		18"x25"x2" (4)		16"x20"x2" (2)	
MAX. CFM/NZ/ZE/SE/MS/FLW RATE																						406 FPM					358 FPM					429 FPM		10		5 GPH		1067 FPM		1067 FPM					1067 FPM					28		8.4 GPH		1322 FPM		1322 FPM					35		1015 GPH		18"x25"x2" (4)		16"x20"x2" (2)						